



# GRAND OPERA HOUSE

BELFAST.

## Social Story

This social story is intended to help you prepare for a new experience and to help you become familiar with the Grand Opera House.

If you would like to offer any feedback, please email [clearn@goh.co.uk](mailto:clearn@goh.co.uk).



This is the **main entrance** of the Theatre.

There are words and pictures on the windows to tell you what shows are happening inside.

When you come to the show, there may be a queue outside.

**Entering the Theatre**



When you walk through the main entrance, you arrive into the **foyer**. A member of staff will ask to see your ticket for the show as you arrive.

Usually there will be people here, who are coming to see the show too.

You can have a seat and relax before the show begins or during the interval. There may be other people sitting at the tables at the back of the foyer.



When you enter the Theatre, you will see **Box Office** to your right.

This is where you can buy tickets for shows. There may be a line of people waiting in front of you to buy or collect tickets.

**Box Office Assistants** sit at the Box Office desk.

They are there to help you.

If you have any questions about shows or if you would like to buy tickets, you can ask a Box Office Assistant.

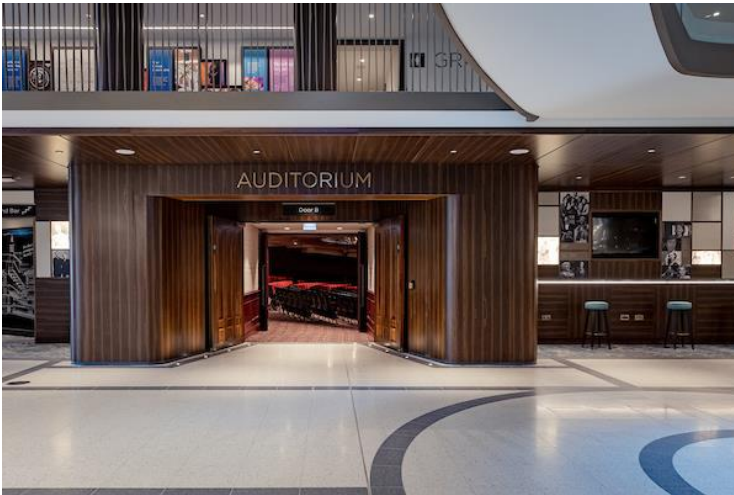

The main **auditorium** is on your left.

This is where you will sit when you are watching the show.

You may go into the auditorium through a different door, depending on where your seat is.

Your ticket will tell you where your seat is, and what door to go use.

Use Door A or Door B if you are sitting in the **Stalls**.

Use Door C or Door D if you are sitting in the **Grand Circle**.

Use Door E or Door F if you are sitting in the **Upper Circle**.

Use Door G if you are sitting in the **Gods**.



This sign tells you what level or floor each area of the Auditorium is on.

**G** – The **Stalls** are on the ground floor.  
**1** – The **Grand Circle** is on the first floor.

**2** – The **Upper Circle** is on the second floor.

**3** – The **Gods** are on the third floor.

You can use the stairs or the lift to get to each floor.



These signs will show you where the **toilets** are located.

There are toilets on the ground floor, the first floor and the second floor.

If you are sitting in the Gods, your nearest toilet is downstairs on the second floor.

There are accessible toilets on the ground floor, on the first floor and the second floor.

If you are unsure where the nearest toilets are, please ask a **host**.

## The Auditorium



When you get to the auditorium, a **Theatre Host** will show you where your seat is.

If you need help to find your seat, or are unsure about anything, please ask.

All of our Theatre Hosts wear Grand Opera House uniforms like the one in this picture.



This is the inside of the **auditorium**, where you sit to watch the show.

There may be a lot of people in here, so it can be noisy sometimes.

### **The Interval**

Half-way through the show, there is a break called the **interval**. This usually lasts for about 20 minutes. During this time, you can go to the toilet, get some snacks or get a drink.

### **The End**

At the end of the show, there may be clapping and cheering. Some people may even stand up to clap. This can be noisy.

After the curtain comes down on the stage, everyone makes their way to the exit and goes home. This can be busy. If you prefer, you can wait in your seat for a few minutes before you leave, so you are not part of the crowd.

Thank you for coming to the Grand Opera House. We hope to see you again soon.